

# FLIP / CLEVERWALL

## INDUSTRIAL PARTITION WALLS

SOLUTIONS FOR DEMARCATING AND SECURING SPACES



# ICON LEGEND



Easy assembly partition walls  
for fast implementation.



Made in France.



24 hr dispatch available,  
please ask.



Compatible swing door.



Compatible sliding door.



# FLIP / CLEVERWALL

## INDUSTRIAL PARTITION WALLS

SOLUTIONS FOR DEMARCATING AND SECURING SPACES



We have listened to you and we understand that your needs when dividing your professional spaces are specific to your sector and business activities.

In response we have designed a complete range of industrial partition walls tailored to your applications and environments to support the development and dynamics of your company.

This catalogue shows our FLIP and CLEVERWALL ranges. 2 solutions developed to respond to your needs for partitions which combine safety and modularity. Here are some possible uses:

- Demarcate areas of activities
- Divide up industrial or logistics buildings
- Create storage areas when organising flows
- Protect sensitive products
- Protect users by controlling access to hazardous zones

Products designed and made in France, based on our passion as manufacturers.

Enjoy the read!

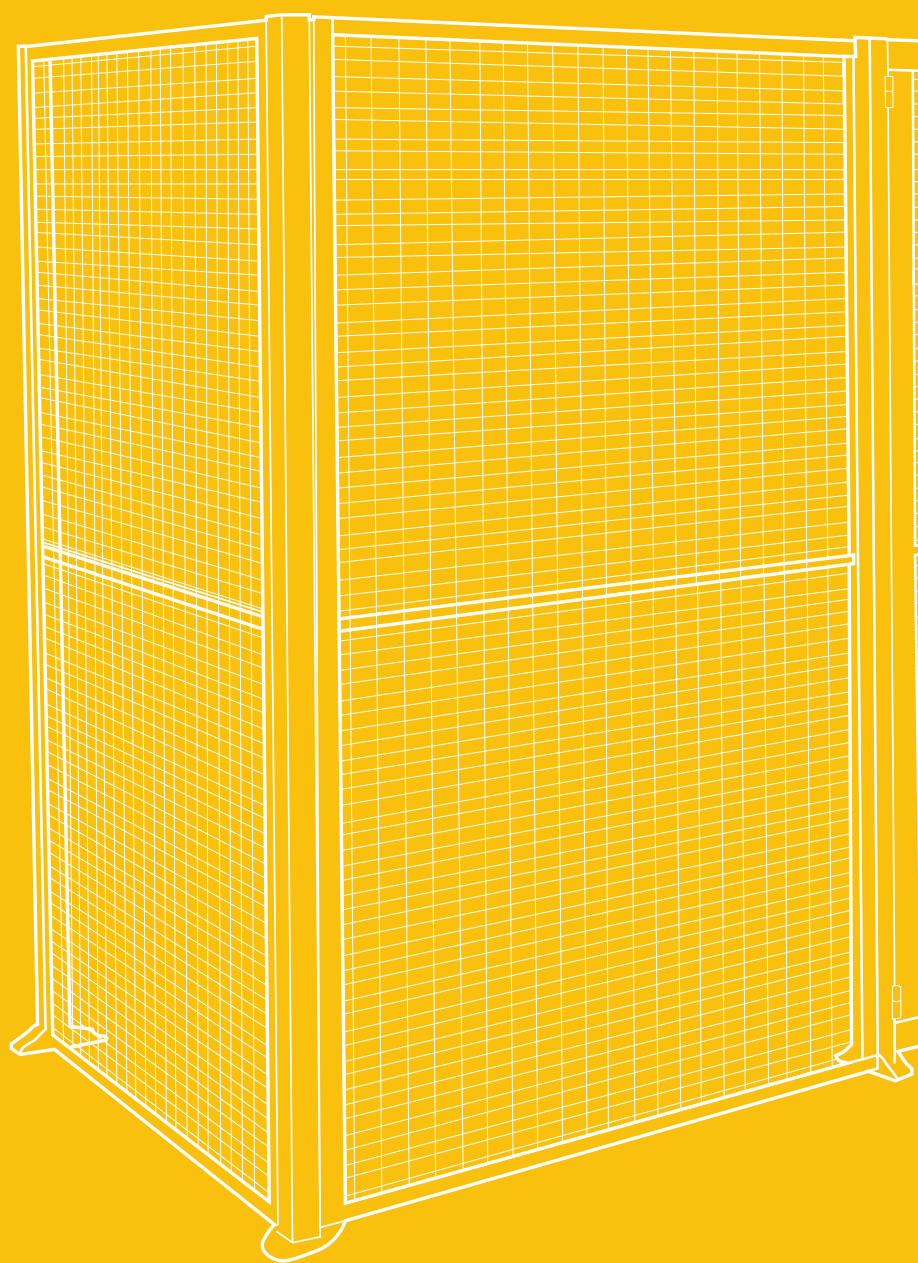



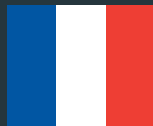

# CLEVERWALL

Cleverwall is a new generation partition wall and combines the latest innovations and technologies in terms of design, manufacture and assembly.

Its finish, safety and solidity make it the perfect solution for all your premises in the most challenging circumstances.



## INTRODUCTION

The first partition wall with a new horizontal mesh of 25 x 50 mm for safer access and better protection of goods. Cleverwall opens up new perspectives for partition walls.

It can be used in numerous configurations thanks to its robust and stable design.

“Monobloc” production of a panel with integrated mesh (up to 2.40m high) offering an aesthetic finish combined with easy, faster assembly.

Mesh, metal sheet or polycarbonate: finishes to mix and match yourself!

Fully compatible with Mezzaman mezzanine floor or our shelving ranges, Cleverwall is the obvious choice for all your projects.

# CLEVERWALL COMPOSITION

## STRUCTURE

The design of Cleverwall is based on 2 main components:

- Uprights to provide stability and maintain verticality
- Panels to define spaces

Doors can be added to control and protect a specific area.

## UPRIGHTS

Their section profile of 50 x 50 mm offers excellent stability from top to bottom.

They come with:

- A factory-welded footplate
- Fastenings for mounting on a concrete floor
- All connecting parts for panels
- A flange cover as finish/protection
- Optional plate guards for a perfect finish

## FINISH

Paint finish in RAL 7024 as standard  
(For available RALs see page 30).

## UPRIGHTS

- Section profile 50x50 mm.
- Thickness 15/10.
- Height from 1750 mm to 3000 mm.
- Lateral perforations for hanging panels.
- Welded plate for floor mounting.
- Floor mounting kit included with uprights.
- Mounting clamps included with panel uprights (quantity according to height).
- Inner protective finish screwed in place when the panels have been installed.

Side View.

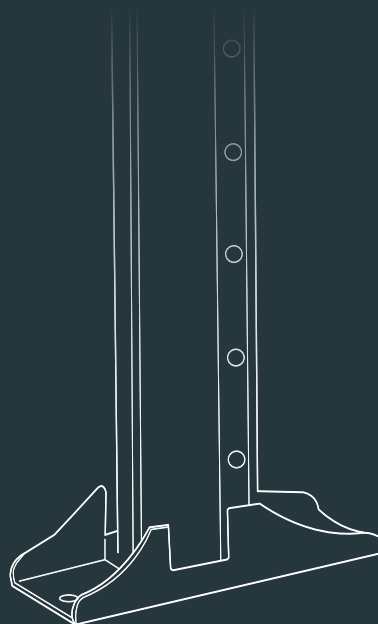

Upright:  
rear view.

Upright cover plate:  
- For a perfect finish  
- Supplied with each  
Cleverwall upright.

Upright with  
cover plate.

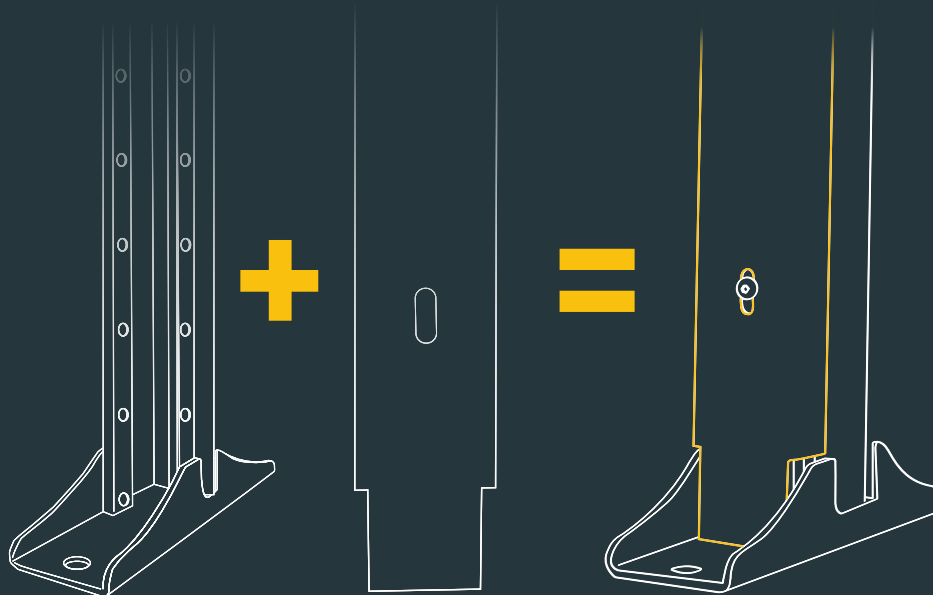

Heights available

2000 mm	2200 mm	2400 mm	2600 mm	2800 mm	3000 mm	And up to 8 meters
---------	---------	---------	---------	---------	---------	-----------------------

\*Available as of 2022



## FOOTPLATE

**A**

- Small size footplate 170 x 58 mm, offering stability and rigidity and a minimum floor footprint both inside and out.
- Two perforations for mounting the upright on the floor.
- Lateral notches ensure perfect alignment when mounting panels.

## FLOOR MOUNTING

**B**

- 2 concrete floor mounts supplied with each:
  - Upright
  - Corner upright
  - Door frame
- A drillhole of  $\varnothing 10$  mm is required for mounting.
- Mounting bush/17 mm wrench.

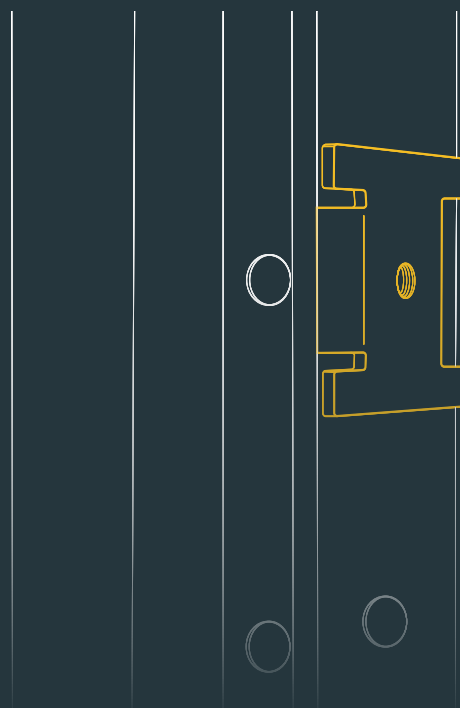
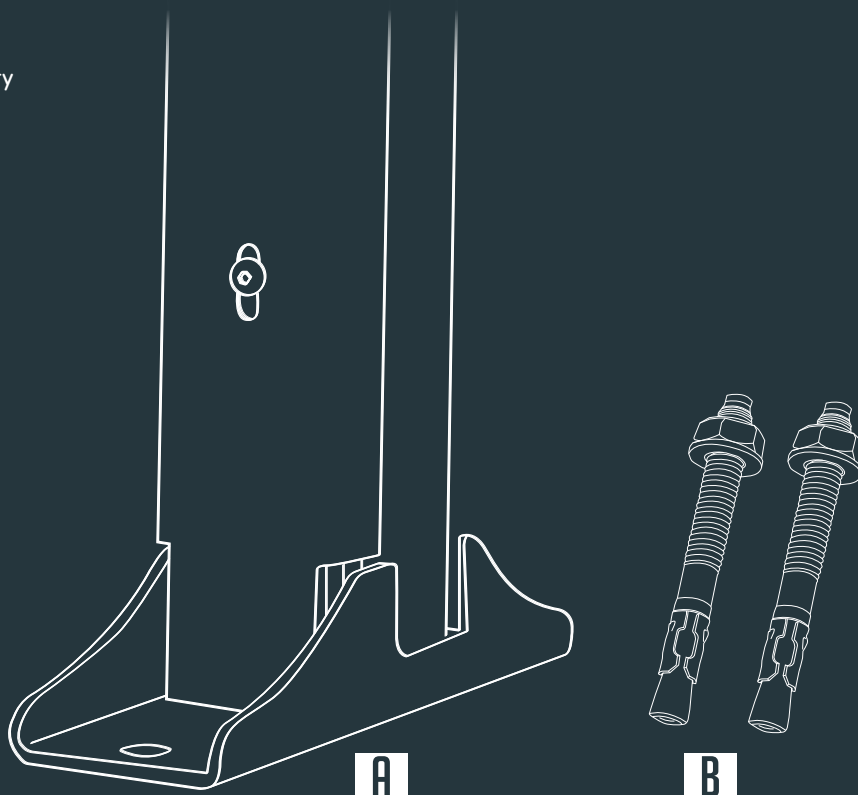

## CLAMP

**C**

- "U" mounting + Phillips screw (PH2, M5 x 18 mm).
- Threaded centre and side of clamp for fast mounting of cover plates and uprights.
- For fast and easy mounting of panels: the panels have perforations at 2 or 3 points (depending on the height of the panel, only 2 or 3 clamps are needed).

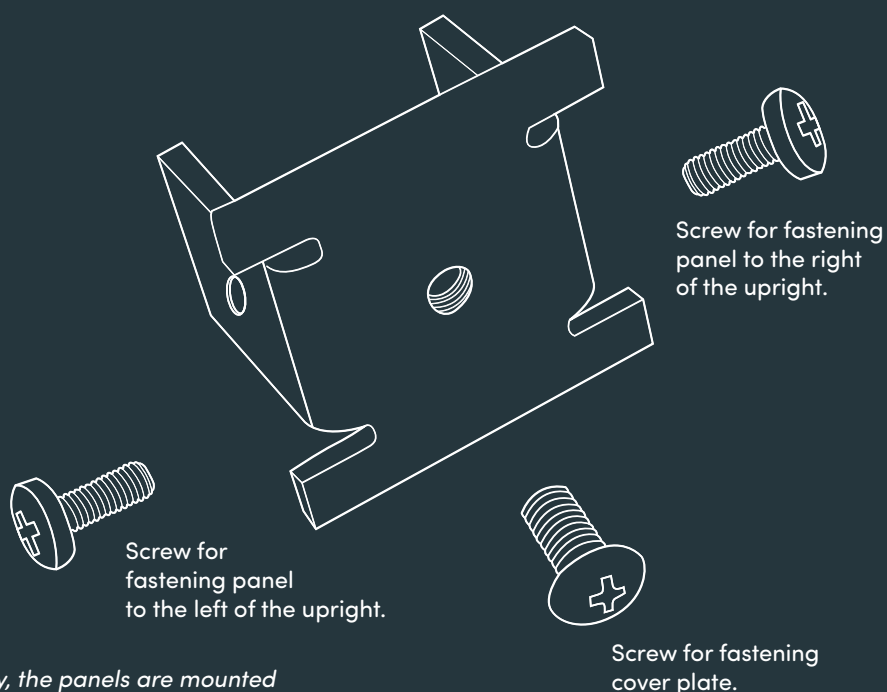

### OUR EXPERT EXPLAINS:

*"For greater freedom and ease of assembly, the panels are mounted independently of each other and each has its separate mounting. Whether you start with the left or the right-hand panel is up to you!"*

*A unique feature which proves its worth when mounting."*

**Benoît, Product Manager**

# CLEVERWALL COMPOSITION

## PANELS

Available in 3 different versions:

- Mesh panel with mesh of 25 x 50 mm, offering a view inside and improving light and ventilation.
- Metal plate panel, with diamond plate sheet, to keep your goods safe, ensure your activities remain confidential and protect users.
- Polycarbonate panel for outer visibility while reducing air flow. All configurations are possible: 100% polycarbonate or in combination with mesh or plate panels.

Mesh and plate panels can be cut to size using the kit provided. This ensures a perfect finish, while maintaining the initial safety aspect and strength of the panels.

## FINISH

Painted panels in standard RAL 7024 (For available RALs see page 30).

## PANELS

- The panels slide into the uprights and are fastened by screws.
- Mounting system (see page 9) for easy assembly.
- Monobloc up to 2.4 meters in height (for mesh version), for even easier mounting and improved finish.
- Aligned with the uprights for an even finish.

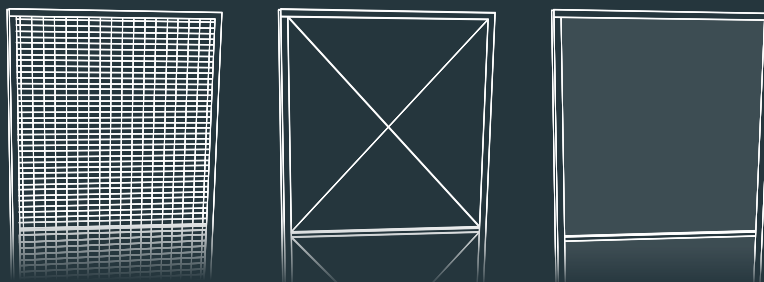

## MESH PANEL

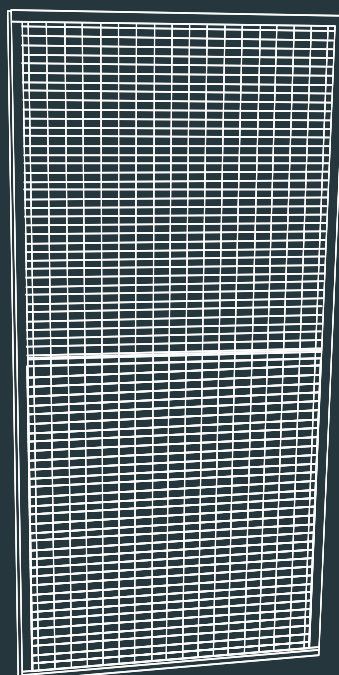

- Mesh 25 x 50 mm combining safety and a contemporary design.

Available dimensions of modules Mesh version							
Height \ Length	600 mm	1000 mm	1100 mm	1200 mm	2000 mm	2200 mm	2400 mm
500 mm	•	•	•	•	•	•	•
750 mm	•	•	•	•	•	•	•
1000 mm	•	•	•	•	•	•	•
1200 mm	•	•	•	•	•	•	•

### Possible heights of partition wall by combining modules:

- H 2600 mm = 2000 + 600 mm
- H 2800 mm = 2200 + 600 mm
- H 3000 mm = 2400 + 600 mm

- Diamond sheet ensuring excellent rigidity of panels (no parasitic vibration).

Sizes available Sheet plate version				
Length \ Height	600 mm	1000 mm	1100 mm	1200 mm
500 mm	•	•	•	•
750 mm	•	•	•	•
1000 mm	•	•	•	•
1200 mm	•	•	•	•

### Possible heights of partition wall by combining modules:

- H 2000 mm = 2 x 1000 mm
- H 2200 mm = 2 x 1100 mm
- H 2400 mm = 2 x 1200 mm
- H 2600 mm = 2000 + 600 mm
- H 2800 mm = 2200 + 600 mm
- H 3000 mm = 2400 + 600 mm

## SHEET PANEL

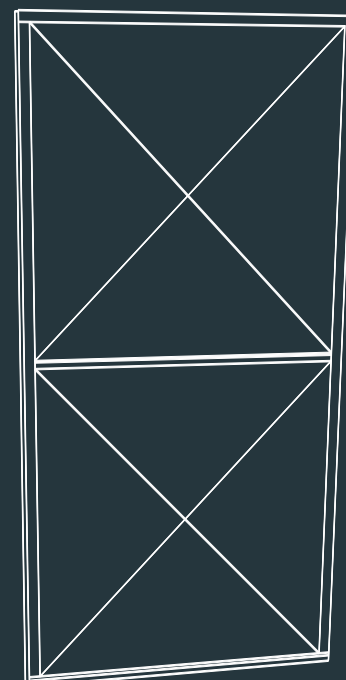

## POLYCARBONATE PANEL

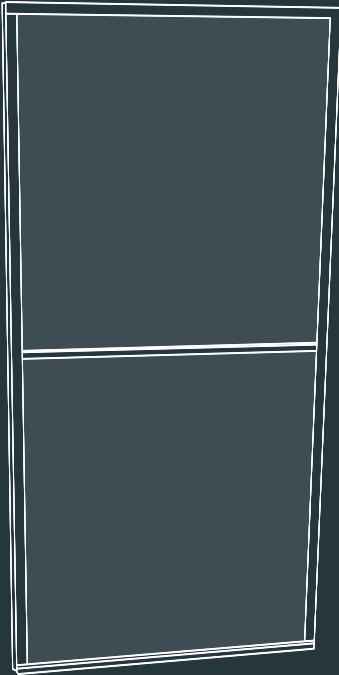

Diagram of a 100% polycarbonate panel.

Available dimensions of modules:  
Polycarbonate version

Height Length	1000 mm	1100 mm	1200 mm
1000 mm	•	•	•
1200 mm	•	•	•

### Possible heights of partition wall by combining modules:

- H 2000 mm = 2 x 1000 mm
- H 2200 mm = 2 x 1100 mm
- H 2400 mm = 2 x 1200 mm
- H 3000 mm = 3 x 1000 mm

- The advantages of polycarbonate compared with Plexiglass:
- Withstands violent impacts (16x harder than Plexiglass of the same thickness).
  - Practically unbreakable.
  - Scratch resistant.
  - Fire class M1 (non-flammable).
  - Recyclable: it can be melted down for re-use almost infinitely.
  - Anti UV treatment for better durability and transparency.
  - Whether fitted with a vertical plate or not, this panel protects the user while allowing a view through the partition.

### OUR EXPERT EXPLAINS:

*"The polycarbonate panel is a separate unit and can be configured as all other standard panels."*

**Benoît, Product Manager**

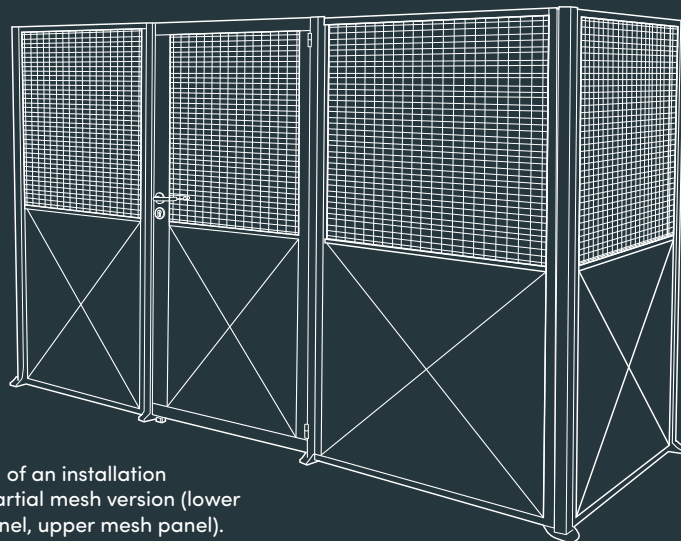
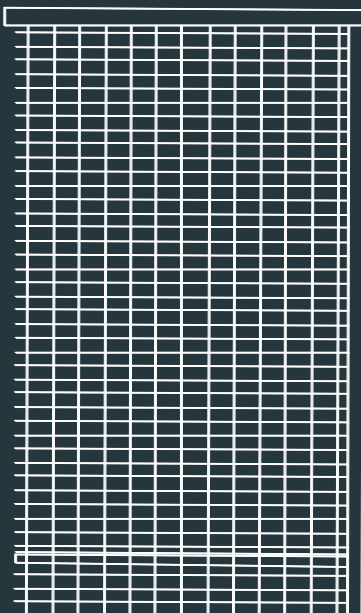
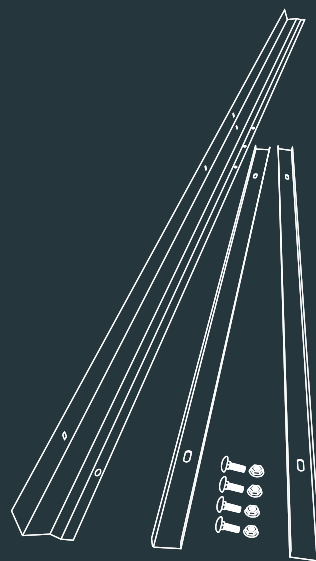

Diagram of an installation with a partial mesh version (lower sheet panel, upper mesh panel).

## PANEL SIZE



Panel can be cut to size.



Kit for fitting panels cut to size.

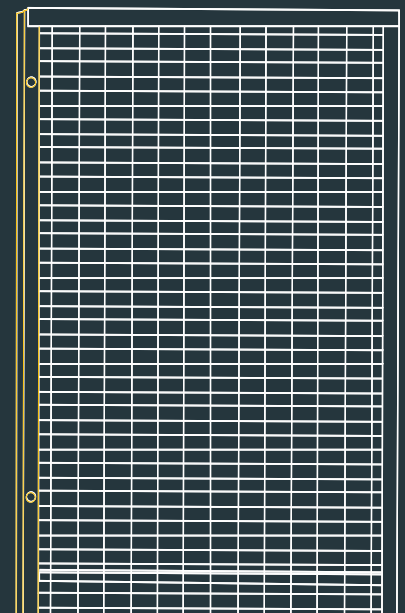

Panel cut to correct size.

# CLEVERWALL TIPS!

Cleverwall certainly lives up to its name -  
and this is why:



## ALIGNMENT

All plates are aligned.  
Positions can be quickly marked out on the floor  
before installing uprights, doors, corner uprights...

### THE BEST THING IS:

- Faster assembly.
- An even appearance throughout.

## PUSH OR PULL?

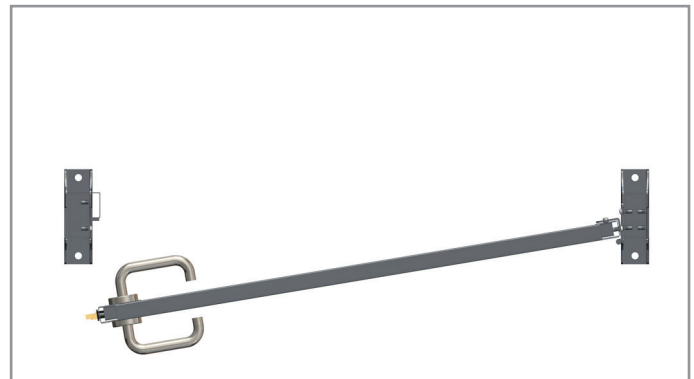
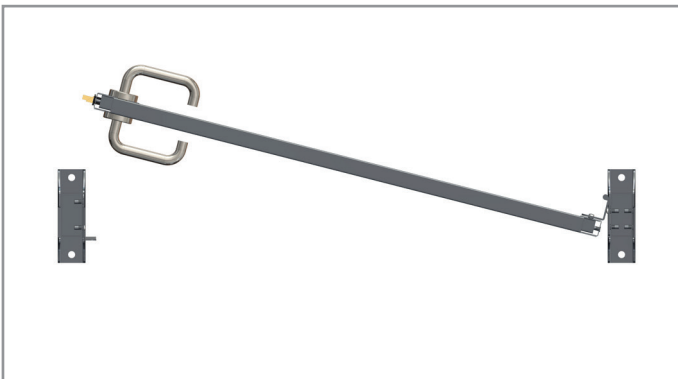

All doors can be reversed during assembly. Simply reverse the hinges to change a push door to pull and vice versa. You just need to decide which side the door will open on (left or right).

### THE BEST THING IS:

- Push or pull: it makes no difference.
- A new project, a modification to your installation? You can make any changes.

## CONNECTIVITY / INTERACTION



You can demarcate an area and integrate it above or below a mezzanine floor with ease! The specially designed Cleverwall connector system offers optimum connection and finish combining the two solutions.



### THE BEST THING IS:

- Optimum connection and finish combining the two solutions.
- Faster assembly.

## FINISH



Identical appearance inside and out for the whole structure. The mesh is protected and the various mountings are covered for a more aesthetic look.



### THE BEST THING IS:

- A REAL solution that combines safety and a contemporary design!

# “CLEVERWALL” ACCESSORIES

## SWING DOORS



### SINGLE SWING DOORS

- Heights: 2000 / 2200 / 2400 mm (to create partitions of heights 2600 mm, 2800 mm and 3000 mm, an upper panel is mounted of 600 mm in height).
- Lengths: 1000 / 1200 / 1500 mm.
- Without upper crosspiece.
- 3 versions:
  - 100% wire mesh.
  - 100% metal sheet.
  - Partial mesh with lower sheet panel.



Example of installation with partial mesh door.



Example of installation with metal plate door.

## SWING DOOR CATCH



### LEVER LOCK WITH KEY

Standard version:

- Euro cylinder lock\*.
- Dimension 30 x 30 mm.
- Supplied with 3 keys.

\*Security cylinder: Cannot be picked, cannot be drilled through, supplied with 5 high-security keys and owner certificate.



## SLIDING DOORS



If a swing door cannot be installed due to lack of space, or if one side is more practical, then sliding doors will match your needs.

### SLIDING DOORS, SINGLE LEAF

- Heights: 2000 / 2200 / 2400 mm.
- Lengths: 1000 / 1200 / 1500 mm.
- 3 versions:
  - 100% wire mesh.
  - 100% metal sheet.
  - Partial mesh with lower sheet panel.

## THE BEST THINGS ABOUT CLEVERWALL:



- Painted sliding rail cover.



- High-security locks with brushed stainless steel handle.



- Optimised door guide for greater convenience.



# FLIP

FLIP is the solution for an effective and economical partition of up to 3 meters.

It can be installed anywhere on your premises, whether production units, warehouses, storerooms...



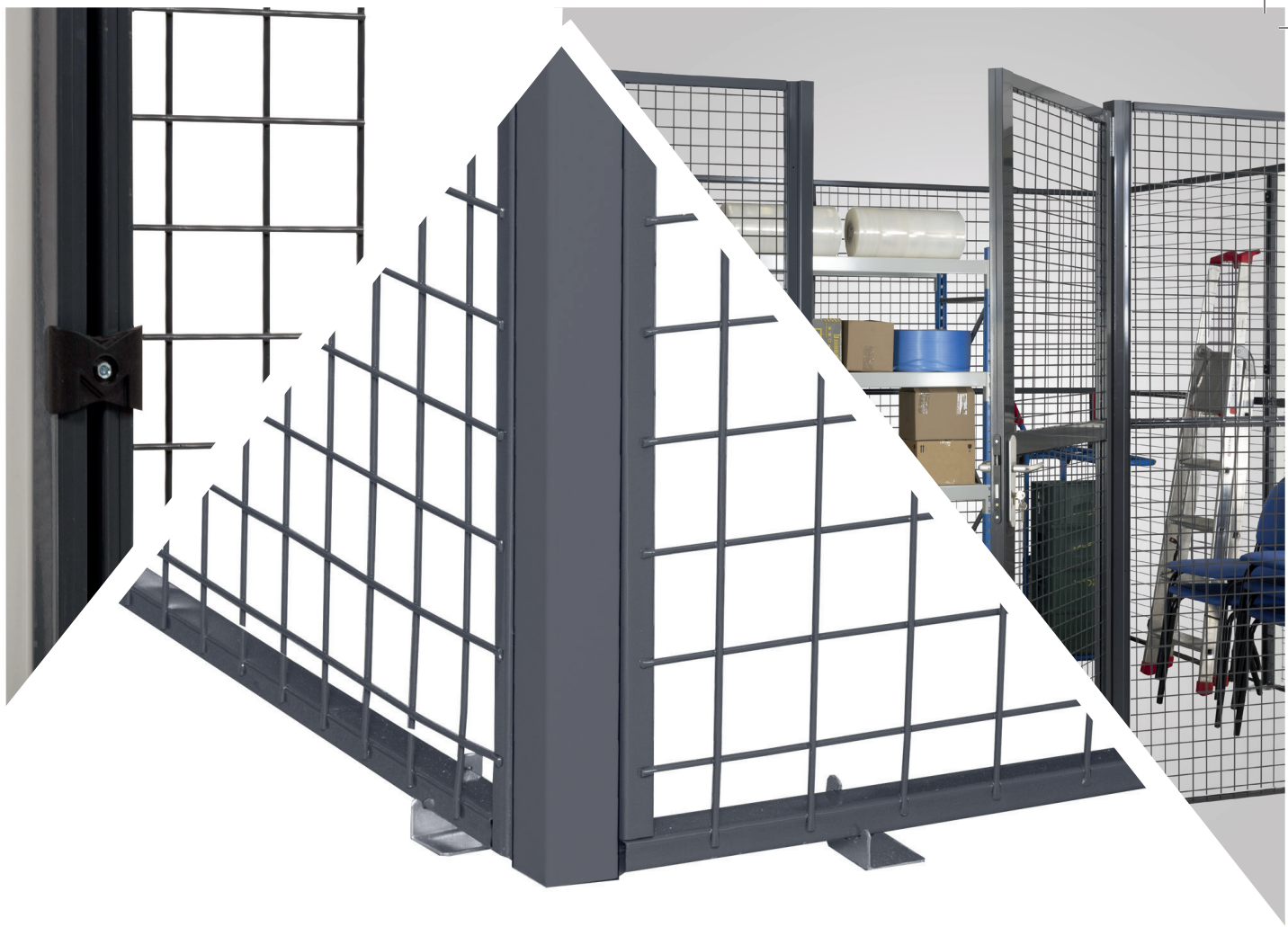

## INTRODUCTION

This partition wall, with its proven price/quality ratio, is intended for demarcating spaces.

Its design of overlapping panels optimises the modularity of the 2 types of available panels (mesh/metal plate) and adapts to the needs of users.

With a standard mesh of 50 x 50 mm, the FLIP partition wall safeguards your goods from theft and protects your employees from dangerous areas.

The metal plate version blocks off the view to ensure complete confidentiality.

With numerous accessories available, such as swing or sliding doors, this solution provides access control to protected areas while allowing for the requirements of the environment (passage of forklifts, restricted area, etc.).

# COMPOSITION OF THE FLIP PARTITION WALL

## STRUCTURE

The FLIP partition wall comprises:

- Uprights with welded footplates.
- Modular panels.
- Panel clamps.
- Swing or sliding doors.

## UPRIGHTS

Vertical support mounted on the floor with the welded footplate.

Maximum height 3 meters. Rapid mounting system included, for single action release or clamping.

## PANELS

Made of welded tubular frames, available in 3 versions:

- Mesh.
- Metal plate.
- White melamine finish.

## FINISH

Paint finish in RAL 7024 as standard (For available RALs see page 30).

## UPRIGHTS

- Section profile 56 x 41 mm.
- Thickness 10/10 up to 2500 mm, thickness 12/10 for heights 2700 to 3000 mm.
- Factory welded plate, size 250 x 51 mm, with perforation floor mounting.
- "M" clamp with special mounting (quantity supplied according to height of uprights).

Upright profile.

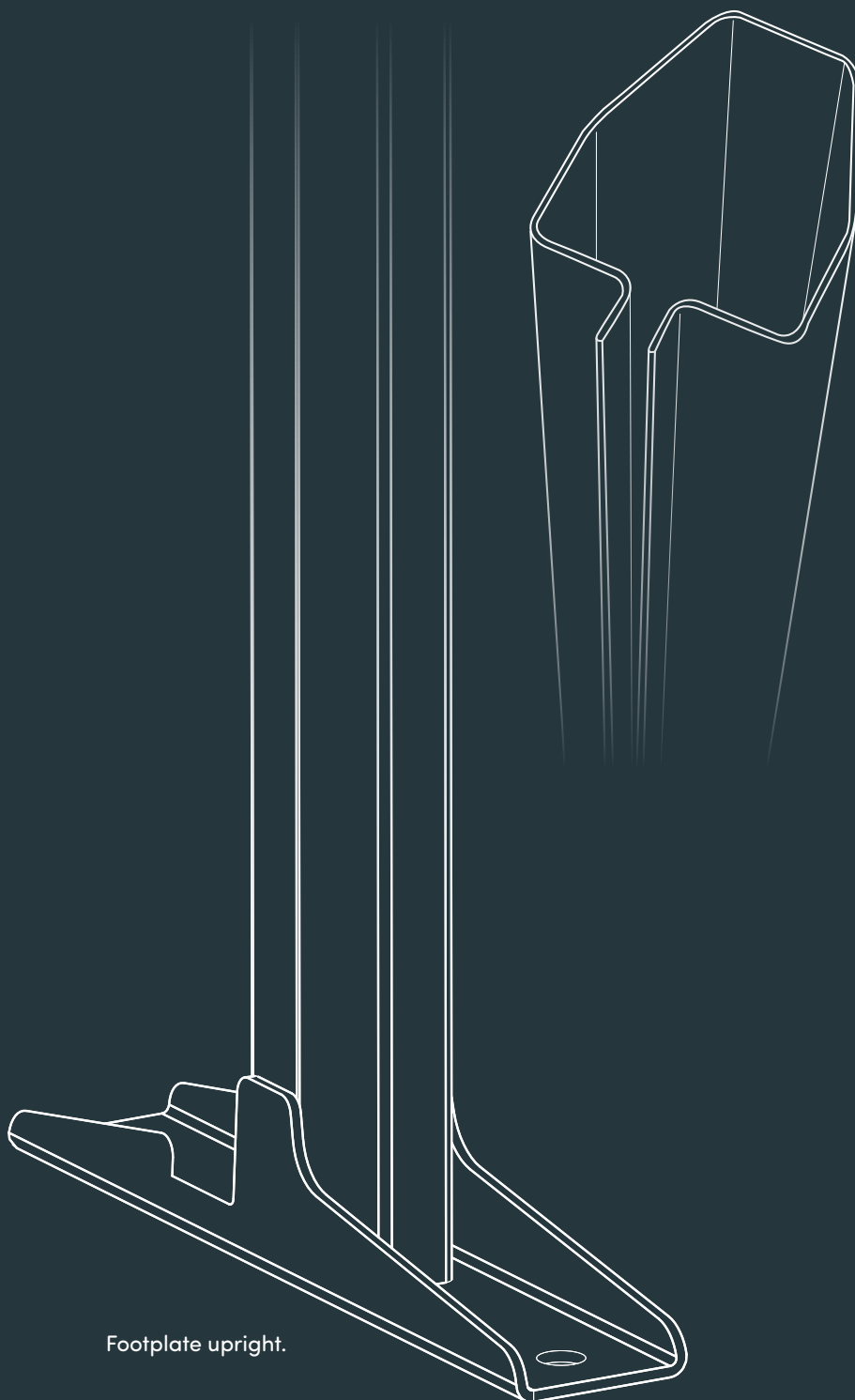

Footplate upright.

Heights of uprights

2000 mm	2200 mm*	2400 mm*	2500 mm	2700 mm	3000 mm*
---------	----------	----------	---------	---------	----------

\*Short production lead times for these heights.

## PANELS

- Structure with frame made of 25 x 15 mm tubes.
- Mesh 50 x 50 mm and wire Ø 3.5 mm.
- Diamond plate.
- Panel with white melamine finish, thickness 19 mm.

Dimensions of panel modules (in mm)

Length \ Height	150 mm	500 mm	750 mm	1000 mm	1200 mm	1500 mm
150 mm	•	•	•	•	•	•
500 mm	•	•	•	•	•	•
750 mm	•	•	•	•	•	•
1000 mm	•	•	•	•	•	•
1200 mm	•	•	•	•	•	•
1500 mm	•	•	•	•	•	•

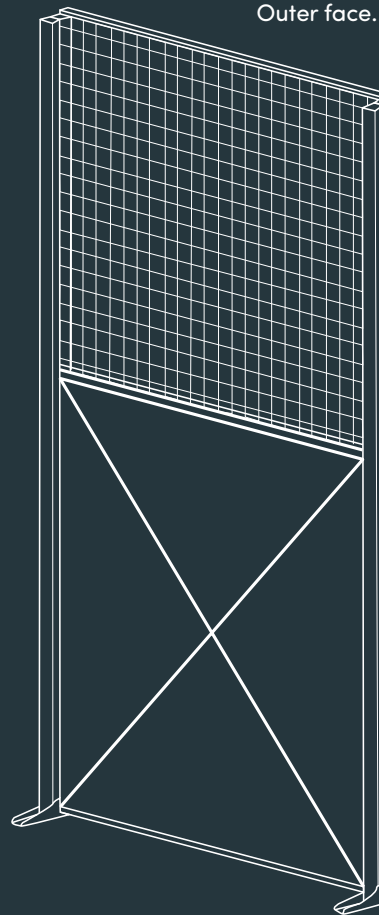

Outer face.

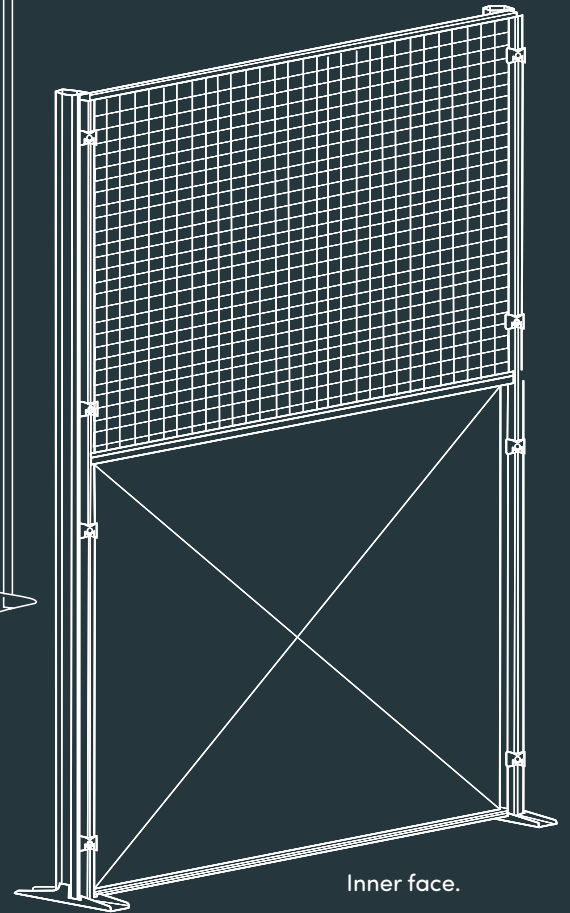

Inner face.

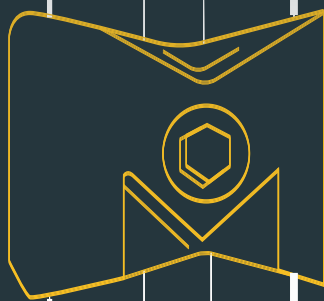

Panel clamp.

## "M" CLAMP

- Optimised 2-in-1 system: the clamp slides into the upright to hold and grip the panels to right and left.
- A single mounting (8 mm connector) holds the panel firmly in place on the upright.

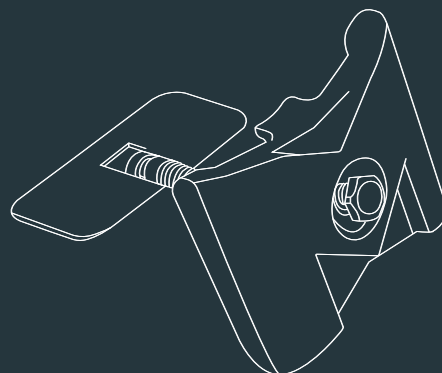

Panel clamp with metal mount.

# FLIP ACCESSORIES

## SWING DOORS



## SINGLE SWING DOORS

- Heights: 2200 / 2400 / 3000 mm.
- Lengths: 1000 / 1200 / 1500 mm.
- 3 versions:
  - 100% wire mesh.
  - 100% metal sheet.
  - Partial mesh with lower sheet panel.

## DOUBLE SWING DOORS

- Heights: 2200 / 2400 / 3000 mm.
- Lengths: 2000 / 2400 / 3000 mm.
- 3 versions:
  - 100% wire mesh.
  - 100% metal sheet.
  - Partial wire mesh.

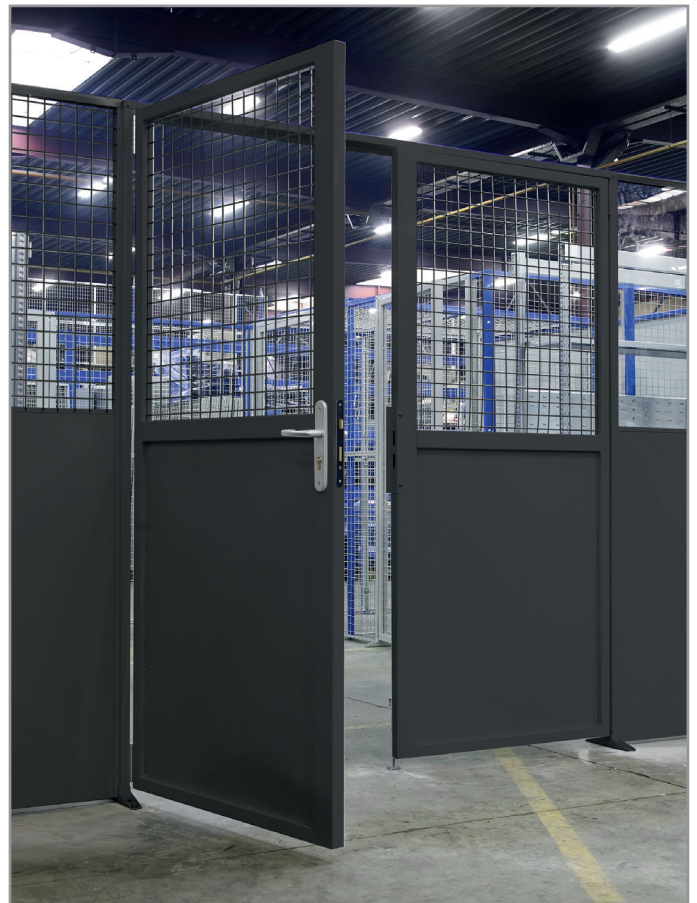

## SWING DOOR LOCKS



### 1 - LEVER LOCK WITH KEY

- Euro cylinder lock, size 30 x 30 mm.
- Supplied with 3 keys.
- Possibility of providing the same keys for all doors, on request.



### 2 - ANTI-PANIC LOCK SYSTEM

- Only available for pull metal plate doors.
- Ideal to respond to requirements in areas with heavy traffic or access to an emergency exit.
- Supplied with exterior key lock.



### 3 - PADLOCK SYSTEM

- Dimensions (height x length): 2200 x 1000 mm.
- The ideal economical solution for storage areas with little traffic.



# FLIP ACCESSORIES

## SLIDING DOORS



## SLIDING DOORS, SINGLE LEAF

- Heights: 2200 / 2400 / 3000 mm.
- Lengths: 1000 / 1200 / 1500 / 2000 / 2400 / 3000 mm.
- 3 versions:
  - 100% wire mesh.
  - 100% metal sheet.
  - Partial mesh with lower sheet panel.

If the door is located in the centre of the partition, double-leaf sliding doors can provide the answer to create a large opening. This solution allows part of the door to be opened on one side and the other part to be opened on the other.

## SLIDING DOORS, DOUBLE LEAF

- Heights: 2200 / 2400 / 3000 mm.
- Lengths: 2000 / 2400 / 3000 mm.



## SLIDING DOOR LOCKS



## FLANGE & LEVER LOCK

- Lock specially for sliding doors.
- The special bracket keeps the door closed.
- Fitted with a Euro cylinder 30 x 30 mm as standard for complete security.



## SERVICE HATCH

- Creating a secure storeroom has never been so easy with the service hatch!
- Create an opening in the partition for easy communicating and protecting your stock.
- Supplied with a shelf of 375 mm width for resting products on.



# EASY AND EFFICIENT ASSEMBLY

## CLEVERWALL



Fast & easy mounting, panel by panel, thanks to the perforations already made in the panels.



Cover plate affixed to the flange.



Uprights mounted on the floor.

## FLIP



Insert the M brackets with the 2 panels.



Tighten the brackets to create the 2-in-1 system: tighten / screw.



Uprights mounted on the floor.





# WHICH PARTITION WALL BEST SUITS WHICH NEED?

## CLEVERWALL



### ROBUST

The sturdy, solid uprights gives Cleverwall unequalled rigidity as well as excellent stability, even for heights of 3 meters or long section lengths.



### SOLID

Its mesh of 25 x 50 mm, unique in the partition wall sector, combines security and a contemporary look.



### SECURE

Cleverwall satisfies this aspects perfectly thanks to the cover plate which hides access to the mountings.

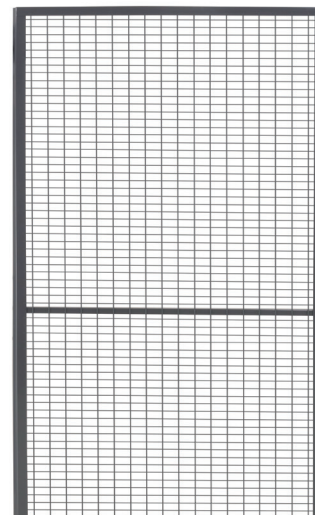

Up to  
2400 mm  
in height

### MONOBLOC PANEL

A Cleverwall exclusive, the mesh panels have a monobloc structure to ensure even faster assembly, a perfect finish and optimum security.

### FINISH

Cleverwall offers an unusual, contemporary look that is unparalleled in the market!

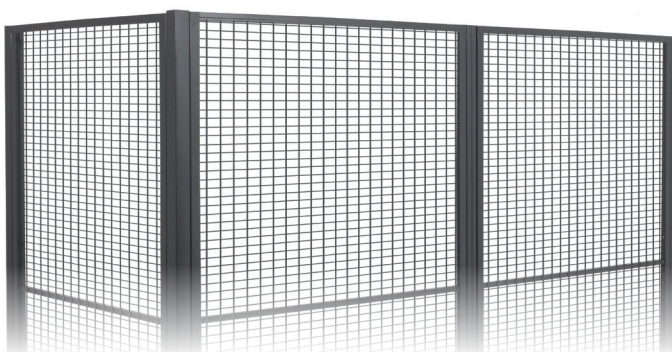

## FLIP



### FUNCTIONAL

The Flip partition wall will satisfy all your current, standard needs. Perfect for demarcating storage areas or for creating a secure space.

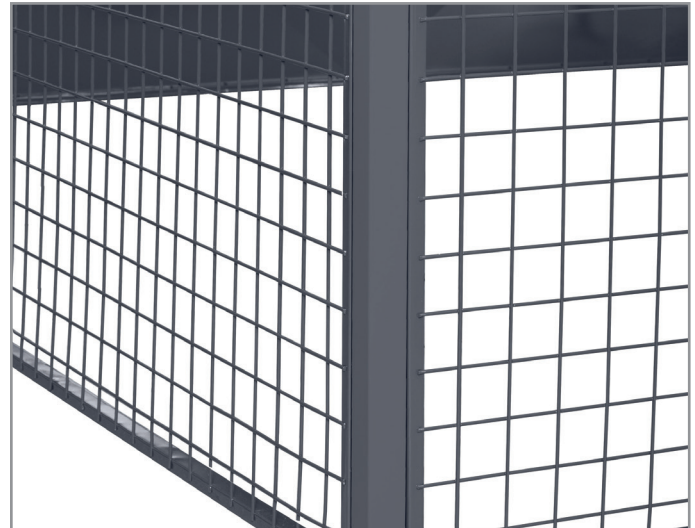

### ECONOMICAL

The perfect answer to projects with a good quality/price ratio thanks to its structure based on the upright profile and a mesh of 50 x 50 mm.



### MODULAR

Modular design; all panels (mesh, plate or mela mine finish) can be combined to create any type of configuration.



### EFFICIENT

The mounting bracket ensures all-in-one clamping and easy, efficient assembly.

**TECHNICAL COMPARISON OF FLIP/CLEVERWALL  
ON NEXT PAGE!**

# TECHNICAL COMPARISON



Features	Flip partition wall	Cleverwall partition wall
<b>Maximum height</b>	3 meters	3 meters 2022: 6 meters
<b>Stability</b>	Stabiliser needed if: - Length $\geq$ 10 meters - Height = 3 meters	Stable solution
<b>Types of panels</b>	- Metal plate, mesh and melamine finish - Modular structure of panels - Maximum height: 1200 mm	- Metal plate, mesh and melamine finish - Monobloc structure - Max. height of mesh partition: 2400 mm - Max. height of metal sheet/Plexiglass partition: 1200 mm
<b>Swing doors</b>	With upper crosspiece (optionally without crosspiece)	Without crosspiece
<b>Sliding doors</b>	- Visible rail guide - Standard finish	- Full cover plates throughout - Superior finish
<b>Handle/lock</b>	- Monobloc lever in gunmetal grey - Standard Euro cylinder - Supplied with 3 keys	- Stainless steel lever with 2 rosettes - Euro cylinder - Supplied with 5 security keys
<b>Mesh</b>	Height x width: 50 x 50 mm	Height x width: 25 x 50 mm
<b>Dimensions of footplate</b>	250 x 50 mm	170 x 58 mm
<b>Mounting panels on upright</b>	- Using "2-in-1" bracket - Mounting left and right panels at the same time	- Using the "C" bracket - Mounting left and/or right panels independently of each other

# EXAMPLES OF INSTALLATIONS



## TAILOR-MADE

The solutions presented in this catalogue reflect a number of installations. With our in-house design office, we are able to design a configuration that will meet the specific requirements of each user.

We know that special cases are becoming ever more frequent! Product managers, R&D and the design office work together to create unique and exceptional installations.

Apart from technical and dimensional constraints, there are no limits placed on your project... Let's take the time, together, to draft your project!

## MANUFACTURE

Sturdiness, safety and aesthetics are the three pillars of our commitment to product quality.

## DELIVERY

We offer an efficient delivery service as part of our overall commitment.

Our teams work hard every day to make sure you are offered a delivery lead time that meets your requirements.

## VISUAL IDENTITY

The colour chart below contains the various RAL shades available for Cleverwall.

Do not hesitate to contact us for any special requests!



**RAL 1013**



**RAL 1028**



**RAL 2004**



**RAL 3000**



**RAL 5010**



**RAL 5015**



**RAL 5018**



**RAL 6011**



**RAL 7024**



**RAL 7035**



**RAL 9005**



**RAL 9006**



**RAL 9010**

Photos: © Adobestock / Manorga

